

Saje®

NATURAL WELLNESS



aromaCloud™

ULTRASONIC DIFFUSER

Please read and save this manual



aromaCloud™

ULTRASONIC DIFFUSER

*Infuse your air with the vitality
and well-being of nature*

TABLE OF CONTENTS

Benefits of Diffusing	1
Recommended Sage Diffuser Blends	2
Product Features	3
Specifications	4
Diagram of Parts	5
Operating Instructions	6-7
Care & Maintenance	8-9
Cautions	10-11
FAQs	12-13

BENEFITS OF DIFFUSING

Diffusing is an easy, heat-free way to enjoy Saje's 100% natural diffuser blends.

This ultrasonic technology, combined with water and a diffuser blend, produces negative ions and aromas that elevate your well-being.

When used with your favorite Saje diffuser blend, the ultrasonic diffuser's refreshing cool mist brings nature's goodness into your space, supporting balance and harmony.

Transform your surroundings with revitalizing air that's reminiscent of fresh mist off a waterfall. Add the Saje diffuser blend of your choice and enjoy fresh, inviting aromas any time.

RECOMMENDED SAJE DIFFUSER BLENDS:

SOOTHING & RELAXING DIFFUSER BLENDS:

- Unwind | Tranquility | Stress Release

REFRESHING DIFFUSER BLENDS:

- Refresh | Exhale | Rain Forest

TRANQUIL DIFFUSER BLENDS:

- Spa Spirit | Mountain High | After the Rain

REVITALIZING AND ENERGIZING DIFFUSER BLENDS:

- Brainstorm | Energy

USE ONLY SAJE DIFFUSER BLENDS; USING OTHER OILS MAY RESULT IN MALFUNCTION.

PRODUCT FEATURES

- Uses an ultrasonic, heat-free system to disperse essential oil molecules into the air.
- May also be used as a humidifier.
- Digitally programmed to stop automatically.
- Energy efficient, whisper-quiet operation and auto shut-off.
- Continuous mist with light on or off.

SPECIFICATIONS

Product Name	aromaCloud
Input Voltage	AC100-240V
Output Voltage	DC24V +/- 5%
Rating Power	12W
Water Tank Capacity	3 fl. oz. (100 ml)
Misting Duration	approx. 6 hours continuous
Mist Output	approx. 4 tsp (+/- 1 tsp) per hour on continuous OR approx. 20 ml (+/- 5 ml) per hour on continuous
Settings	continuous mist with light on or off
Light Options	LED light; rotating color, steady color or off
Coverage Area	approx. 100-300 sq ft
Dimensions	approx. (D) 7" x (H) 3" or (D) 175 mm x (H) 80 mm
Net Weight	approx. 10 oz (272 g)
Main Materials	cover: PBT-S; water tank: PBT-S

DIAGRAM OF PARTS

- A. Cover
- B. Max. Water Level Line
- C. Air Outlet
- D. Water Tank
- E. Mist Output
- F. On/Off Buttons
- G. DC Power Jack
- H. Power Adapter
- I. LED Light
- J. Ceramic Disc
- K. Measuring Cup

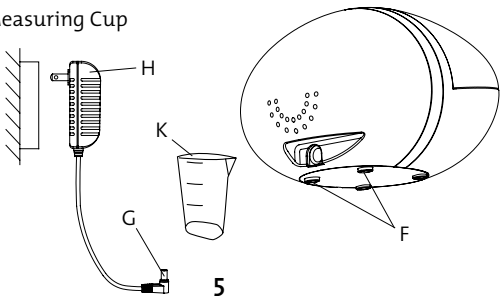
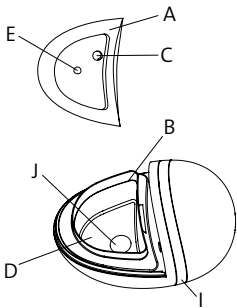

OPERATING INSTRUCTIONS

1. Remove the cover from the unit to expose water tank.

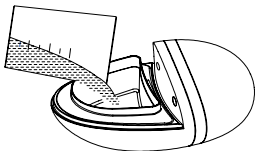
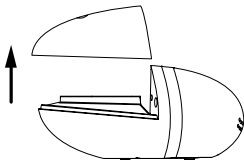

2. Using the measuring cup provided, fill water tank with room temperature tap water to no higher than max. water level line (3 fl.oz./ 100 ml).

3. Add 10-15 drops (depending on preference) of your favorite Saje diffuser blend to the water.

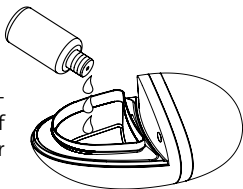

4. Replace the cover and ensure that it fits properly onto unit.
5. Connect power adapter to DC power jack on back of unit.

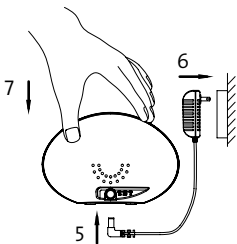
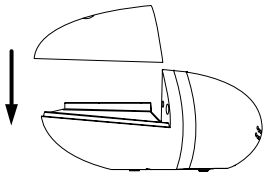

6. Plug power adapter into electrical outlet.
7. Press the back half of the unit to turn on. Press once to mist with light on, press a second time to mist with light off; press a third time to turn unit off.

8. Unit will turn off automatically when water in water tank reaches minimum water level (approx. 0-3 tsp/ 0-15 ml).
9. Use only Saje diffuser blends; using other oils may result in malfunction.

PLEASE NOTE: RUN TIMES AND AMOUNT OF WATER LEFT IN THE TANK AFTER AUTO SHUT-OFF WILL VARY DUE TO CLIMATE, ENVIRONMENT AND OTHER FACTORS.

CARE & MAINTENANCE

- If the unit is knocked over while in operation, water could leak into the internal mechanism of the unit; if this occurs, unplug from power, empty water and let unit dry out in well-ventilated area for at least 3 days.
- Turn off unit and unplug from the power adapter prior to cleaning.
- Remove cover and empty water from the water tank, carefully avoiding the air outlet side.
- If required, use a clean, soft, damp cloth to wipe down exterior of unit.
- Frequency of necessary cleaning is dependent upon usage and types of diffuser blends used (ie. how thick the essential oils are in the diffuser blend).

- To clean inside water tank, dispense a few drops of rubbing alcohol into tank and wipe with a clean, soft cloth.
- To clean ceramic disc at bottom of water tank, dispense a few drops of rubbing alcohol onto a clean cotton swab and wipe clean.
- The ceramic disc should be kept clean of mineral deposits and other debris for optimal misting. NEVER use any sharp objects to clean the ceramic disc as this will damage the disc permanently.
- For optimum results, clean the water tank before changing diffuser blends.

CAUTIONS

- Only use the power adapter supplied with the device.
- Never operate the device if the power adapter is damaged.
- Do not use if any part of the device is broken.
- To reduce the risk of electric shock, do not attempt to service the device in any way other than as described in the “Care & Maintenance” section of this manual.
- Do not disassemble or attempt to repair unit; in the event of a problem, please contact 1-877-ASK-SAJE.
- When moving the device, hold securely by the base.
- Do not touch the highly sensitive ceramic disc with bare fingers.
- Always place the unit on a stable, level surface.
- Do not fill water tank directly from tap as water could spill into the internal mechanism and cause damage.
- Do not plug the unit into the wall socket with wet hands.
- To prevent damage to the ceramic disc, only use tap water at room temperature.
- Do not pour water or other liquid into the air outlet.

- Do not tilt, move or attempt to empty or refill unit while in operation.
- To prevent clogging and damage to the ceramic disc, always use clean water.
- Remove any liquid left in the water tank after each use.
- Always turn off and unplug the device during maintenance or when not in use.
- Ensure that the power adapter is not covered or blocked when plugged in; it must be able to dissipate the heat properly.
- Use only Saje diffuser blends; other oils may contain fragrances, base oils or synthetics that could result in malfunction. Some single note essential oils are also too thick or heavy for use in the ultrasonic diffuser. See FAQs for more information.
- In case of smoke, unusual aroma, undue noise, or other malfunction, unplug the unit immediately and discontinue use. Further use may result in fire or electrical shock.
- Do not overfill or immerse the unit in water.
- Always keep unit out of reach of small children and pets.

FAQs

Q: WHAT IF MY UNIT DOES NOT TURN ON?

Power adapter may not be properly plugged in; ensure that the power adapter is properly plugged into the DC power jack and the electrical source.

Q: WHAT IF MY UNIT DOES NOT MIST OR THERE IS ALMOST NO MIST?

There may not be enough water in the water tank; ensure that the water tank is filled to the maximum water level line.

The water level may be too high (higher than the maximum water level line); pour out excess water and try again.

The ceramic disc may require cleaning. Please see “Care & Maintenance” instructions.

Q: WHAT TYPE OF WATER SHOULD GO INTO MY ULTRASONIC DIFFUSER?

To prevent damage to the unit, it's recommended to use room temperature tap water. To prevent clogging and damage to the ceramic disc, always use clean water.

Q: WHAT CAN I PUT IN MY ULTRASONIC DIFFUSER?

Use only 100% natural Saje diffuser blends; other blends and oils may contain fragrances, base oils or synthetics that could result in malfunction.

Many single note essential oils should not be used in the ultrasonic diffuser. Single note essential oils may have a thick or heavy consistency that can clog the ultrasonic diffuser and cause it to stop working.

Saje diffuser blends have been carefully blended to be effective for you, and safe and easy to use in your ultrasonic diffuser.

Distributed by: **SAJE NATURAL WELLNESS**

500 - 88 EAST PENDER ST. VANCOUVER, BC CANADA V6A 3X3
SAJE.COM | 1-877-ASK-SAJE | MADE BY OUR FRIENDS IN CHINA

WE SUPPORT RECYCLING. PLEASE RECYCLE WHERE POSSIBLE.