



AROMA LIGHT

electric diffuser

diffuseur électrique

Please read and save this manual



AROMA LIGHT

electric diffuser
diffuseur électrique



*Infuse your air with the vitality
and well-being of nature*

TABLE OF CONTENTS

BENEFITS OF DIFFUSING	1
PRODUCT FEATURES	2
SPECIFICATIONS	3
DIAGRAM OF PARTS	4
OPERATING INSTRUCTIONS	5
CARE AND MAINTENANCE	6
REPLACING THE HALOGEN BULB	7
CAUTIONS	8
FCC & IC STATEMENTS	10
FAQs	12

BENEFITS OF DIFFUSING

Diffusing essential oils into the air supports well being through the sense of smell and creates a supportive atmosphere.

PRODUCT FEATURES

- Tap on/tap off technology
- Silent operation
- Decorative metal cover

SPECIFICATIONS

PRODUCT NAME	Aroma Light
INPUT VOLTAGE	AC110V
OUTPUT VOLTAGE	110V
RATING POWER	35W max.
WATER BOWL CAPACITY	fill to max 1.2 fl oz 35 ml
SETTINGS	light on/off control
LIGHT OPTIONS	warm halogen light on/off control with 3 brightness settings
BULB REPLACEMENT TYPE	35W G5.3 halogen
DIMENSIONS	approx. (D) 3.9" x (H) 10.2" or (D) 100 mm x (H) 260 mm
NET WEIGHT	approx. 24.7 oz 700g
MAIN MATERIALS	outer cover: metal; water bowl: glass; water bowl holder: metal

DIAGRAM OF PARTS

- A. WATER BOWL
- B. WATER BOWL HOLDER
- C. HALOGEN BULB
- D. METAL BASE
- E. DC POWER JACK

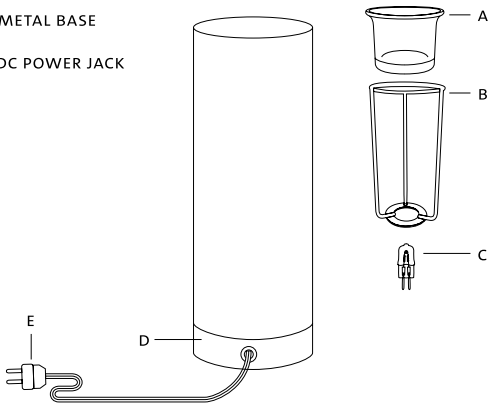

OPERATING INSTRUCTIONS

1. Remove the water dish from diffuser and fill 3/4 full with fresh tap water. Do not fill the water dish while over-top of the halogen bulb.
2. Add 10-15 drops (depending on your preference) of your favorite Saje diffuser blend.
3. With unit unplugged, carefully lower water bowl into holder.
4. Plug unit into electrical outlet and turn on unit by tapping once anywhere on the metal base. Tap twice for a brighter light and three times for maximum brightness. Tap a fourth time to turn unit off.

☀️ TAP TWICE: Brighten light

☀️ TAP THREE TIMES:
Maximum brightness

⏻ TAP A FOURTH TIME: Unit off.

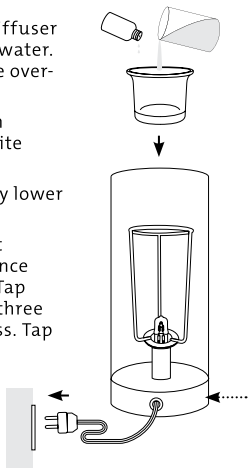

5. As the water warms, the essential oils will fill the air.
6. To use as a lamp only, turn off unit, remove water bowl once cooled down and then turn back on to your preferred brightness setting.

CARE AND MAINTENANCE

- Turn unit off and allow to cool down completely before cleaning.
- Do not allow the interior of the unit's base to get wet; the outside may be wiped with a soft damp cloth.
- Essential oil residue in the water bowl may be cleaned using rubbing alcohol and a soft cloth or paper towel.

REPLACING THE HALOGEN BULB

1. Turn unit off, unplug and let it cool for at least 10 minutes.
2. Carefully pull up the water bowl holder avoiding contact with bulb to reveal the bulb.
3. Use a soft cloth to grasp the bulb and gently pull upwards to remove bulb. Do not twist the bulb. Avoid handling the new bulb with bare hands as this will reduce the life of the bulb.
4. Insert the new bulb by aligning the bulb prongs with the holes in the base and gently press down. Do not twist bulb. Ensure that the bulb is sitting securely in the base.

CAUTIONS

- Place on heat-resistant surface.
- Do not place beside flammable materials as exterior of unit emits heat during use.
- Do not move unit while in use or until unit has cooled down. Water will get hot and could cause injury/ burns if spilled on skin.
- Avoid contact with exterior of unit during use as the metal housing can become hot.
- Do not lower water bowl into unit when unit is plugged in; make sure water bowl is secure before plugging in and turning on the unit.
- Never leave diffuser unattended while turned on.
- While unit is on, water will warm up and evaporate; do not allow unit to run dry; turn off unit when water bowl is empty.
- Do not add water or essential oils to the glass bowl while placed in lamp.

- Allow water bowl to cool before refilling to prevent cracking.
- Do not look directly at bulb when lit and refrain from touching bulb until unit is unplugged and has cooled.
- For indoor use only.
- Do not use if any component is broken.
- Turn off and unplug when not in use.
- Use only with 35W G5.3 halogen bulb.
- Keep out of reach of children and pets.
- Do not plug in with wet hands.

FCC & IC STATEMENTS

This device complies with Part 15 of the FCC rules. Operation is subject to the following two conditions:

- 1) This device may not cause harmful interference, and
- 2) This device must accept any interference received, including interference that may cause undesired operation.

This equipment has been tested and found to comply with the limits for a Class B digital device, pursuant to part 15 of the FCC Rules. These limits are designed to provide reasonable protection against harmful interference in a residential installation. This equipment generates, uses and can radiate radio frequency energy and, if not installed and used in accordance with the instructions, may cause harmful interference to radio communications. However, there is no guarantee that interference will not occur in a particular installation. If this equipment does cause harmful interference to radio or television reception, which can be determined by turning the equipment off and on, the

user is encouraged to try to correct the interference by one or more of the following measures:

- Reorient or relocate the receiving antenna.
- Increase the separation between the equipment and receiver.
- Connect the equipment into an outlet on a circuit different from that to which the receiver is connected.
- Consult the dealer or an experienced radio/TV technician for help.

Changes or modifications not expressly approved by Saje Natural Wellness Canada could void the user's authority to operate this equipment. This device complies with Part 18 of the FCC Rules and ICES 001. Although this product is tested and complies with FCC, it may interfere with other devices. If this product is found to interfere with another device, separate the other device and this product. Conduct only the user maintenance found in this instruction manual. Other maintenance and servicing may cause harmful interference and can void the required FCC compliance.

FAQS

Q: WHAT IF MY UNIT DOES NOT TURN ON?

The power adapter may not be properly plugged in; ensure that the power adapter is properly plugged into the electrical source.

The bulb may need replacing. Please see "Replacing the Halogen Bulb" instructions.

Q: HOW DOES THIS DIFFUSER WORK COMPARED TO MY ULTRASONIC DIFFUSER?

This unique diffuser is designed to gently heat your favorite oils by lightbulb, creating a subtle aroma in the air and a soft decorative glow. As the unit is not ultrasonic, air purification and humidification are not the primary purposes of this diffuser, though you will still experience the same therapeutic properties of your essential oils.

Q: ARE THERE ANY BLENDS OR OILS TO AVOID USING?

As this unit diffuses with water and gentle heat, all Saje essential oils (including those found in roll-on blends) can be used.

Imported and distributed by / Importé et distribué par :
SAJE NATURAL WELLNESS 22 EAST 5TH AVE VANCOUVER, BC
CANADA V5T 1G8 | SAJE.COM | 1-877-ASK-SAJE | @SAJEWELLNESS
MADE BY OUR FRIENDS IN CHINA. FABRIQUÉ EN CHINE
I'M MADE FROM RECYCLED PAPER. *please recycle where possible*